

FOR R/W DATA - SEE RTWY PLANS.

DATE RECEIVED	DATE FILED	DATE REMOVED	DATE FILED	FED. R-40 NO	STATE	FED. R-10 FED.	FISCAL YEAR	SERIAL NO.
4-7-72 630-53-73				6	ARK.			
JOB NO.								
3								

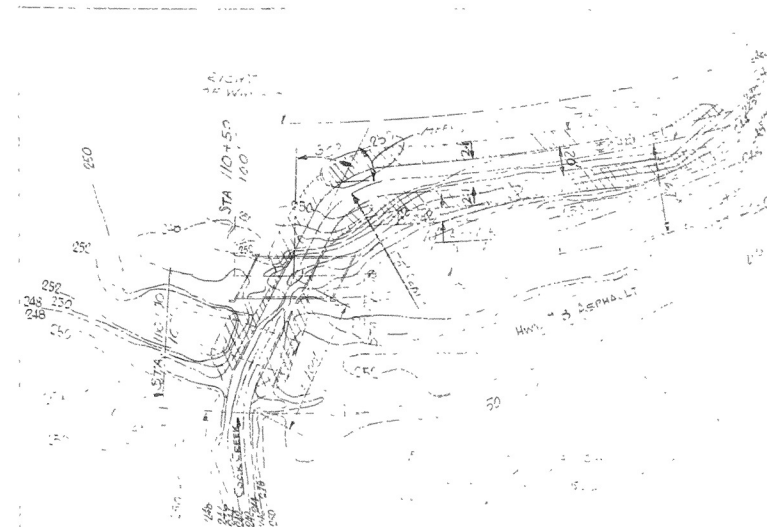
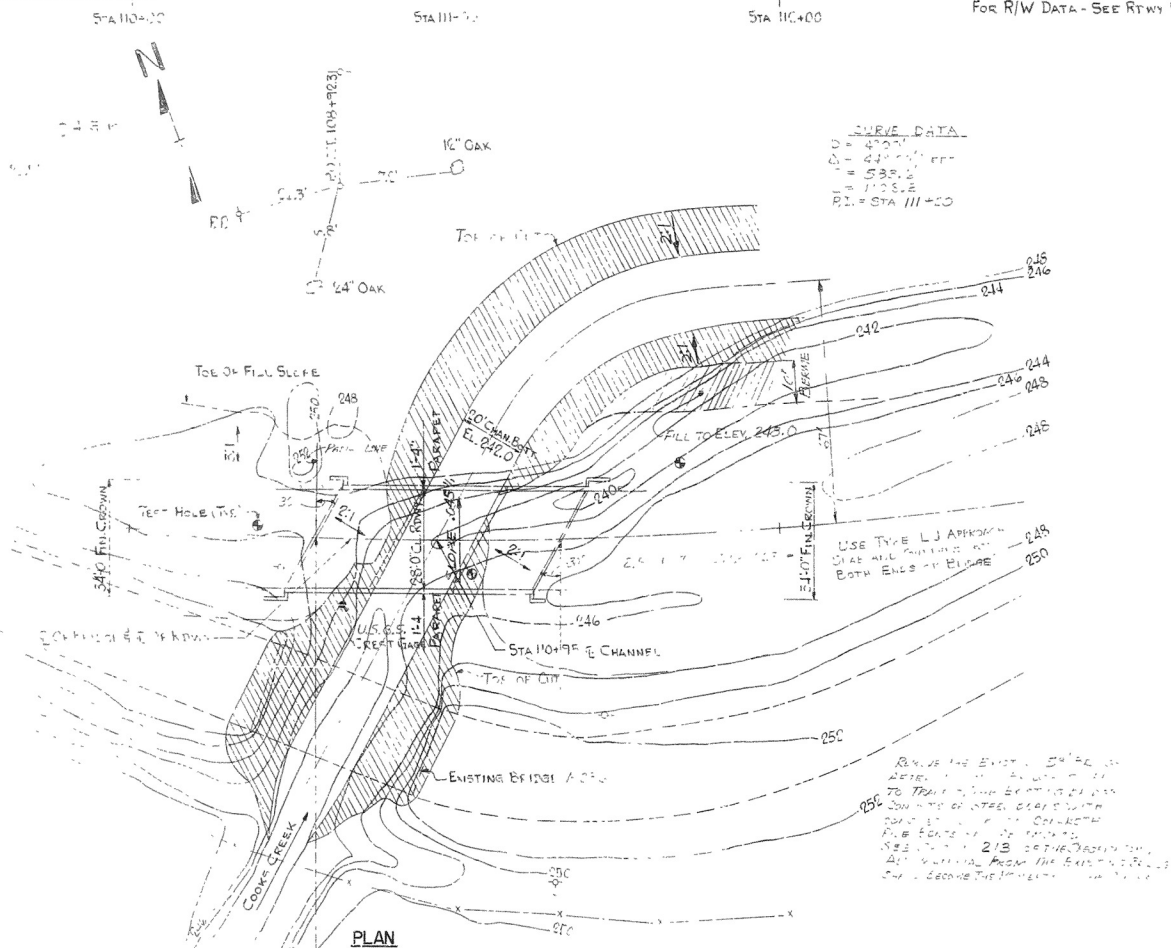

LOCATION SKETCH  
1 = 50'-0"

## GENERAL PRINCIPLES

FENCH MARK - SQUARE CUT IN HIGH PALE, 30 FEET RIGHT OF STATION, BY 29,  
ELEVATION 254.27.

ALL PILING SHALL BE 16" OCTAGONAL PRECAST CONCRETE AND SHALL BE DRIVEN WITH AN APPROVED AIR, STEAM, OR DIESEL HAMMER TO A MINIMUM ENDING CAPACITY OF 44 TONS PER PILE. AND TO A MINIMUM PENETRATION OF 20 FEET BELOW THE GROUND LINE. LENGTHS OF PILING SHOWN ARE ASSUMED FOR ESTIMATING QUANTITIES ONLY. ACTUAL LENGTHS TO BE DETERMINED FOR EACH FIELD. DRIVE ONE 35' TEST PILE IN FIELD 1.

#### PILES IN END PENTS TO BE DRIVEN AFTER EMBANKMENT

ALL PROJECTS SHALL BE COMPLETED BY 12/31/05.

FOR DETAILS OF EVENTS, SEE PAGES 40-41

FOR D-TYPE OF 25' R.C. SLAB SPAN, 5' DIA.  
FOR D-TYPE OF 30' R.C. SLAB SPAN, 5' DIA.

- DECEMBER 1976 - ARKANSAS STATE LIBRARY - 11

SPECIFICITY OF THE HIGH-VOLTAGE GEL PERMEATION CHROMATOGRAPHY

U.S.C. § 2003(b)(1) (50 U.S.C. § 3605(b)(1)).

1520

J. STRESSES. CLASS: TWO, DATE: 11/11/1964.

LAYOUT OF BRIDGE OVER  
COOKS CREEK  
HWY. 79-NORTHWEST  
DALLAS COUNTY  
ROUTE 8 SEC. 7

ARKANSAS STATE HIGHWAY COMMISS  
LITTLE ROCK, ARK.

LITTLE ROCK, ARK.

DRAWN BY: \_\_\_\_\_ DATE: \_\_\_\_\_  
 TRACED BY: \_\_\_\_\_ DATE: \_\_\_\_\_ SCALE: 1" = 20'-  
 CHECKED BY: \_\_\_\_\_ DATE: \_\_\_\_\_  
 BRIDGE NO. 5438 DRAWING NO. 174

DRAWING NO. 174